

Pioneer *sound.vision.soul*

DVD/CD Receiver

XV-DV232

XV-DV240

XV-DV131

Speaker System

S-DV232

S-DV340ST

S-DV240SW

S-DV131



RW
COMPATIBLE

Operating Instructions

Location: rear of the unit

IMPORTANT



The lightning flash with arrowhead symbol, within an equilateral triangle, is intended to alert the user to the presence of uninsulated "dangerous voltage" within the product's enclosure that may be of sufficient magnitude to constitute a risk of electric shock to persons.

CAUTION

**RISK OF ELECTRIC SHOCK
DO NOT OPEN**

CAUTION:
TO PREVENT THE RISK OF ELECTRIC SHOCK, DO NOT REMOVE COVER (OR BACK). NO USER-SERVICEABLE PARTS INSIDE. REFER SERVICING TO QUALIFIED SERVICE PERSONNEL.



The exclamation point within an equilateral triangle is intended to alert the user to the presence of important operating and maintenance (servicing) instructions in the literature accompanying the appliance.

D3-4-2-1-1_En-A

Replacement and mounting of an AC plug on the power supply cord of this unit should be performed only by qualified service personnel.

IMPORTANT FOR USE IN THE UNITED KINGDOM

The wires in this mains lead are coloured in accordance with the following code:

Blue : Neutral

Brown : Live

If the plug provided is unsuitable for your socket outlets, the plug must be cut off and a suitable plug fitted.

The cut-off plug should be disposed of and must not be inserted into any 13 amp socket as this can result in electric shock. The plug or adaptor or the distribution panel should be provided with 5 A fuse. As the colours of the wires in the mains lead of this appliance may not correspond with coloured markings identifying the terminals in your plug, proceed as follows :
The wire which is coloured blue must be connected to the terminal which is marked with the letter N or coloured black.
The wire which is coloured brown must be connected to the terminal which is marked with the letter L or coloured red.

Do not connect either wire to the earth terminal of a three pin plug.

NOTE

After replacing or changing a fuse, the fuse cover in the plug must be replaced with a fuse cover which corresponds to the colour of the insert in the base of the plug or the word that is embossed on the base of the plug, and the appliance must not be used without a fuse cover. If lost replacement fuse covers can be obtained from your dealer. Only 5 A fuses approved by B.S.I or A.S.T.A to B.S.1362 should be used.

D3-4-2-1-2-2_En

CAUTION : USE OF CONTROLS OR ADJUSTMENTS OR PERFORMANCE OF PROCEDURES OTHER THAN THOSE SPECIFIED HEREIN MAY RESULT IN HAZARDOUS RADIATION EXPOSURE.

CAUTION : THE USE OF OPTICAL INSTRUMENTS WITH THIS PRODUCT WILL INCREASE EYE HAZARD. D6-8-2-1_En

WARNING

This equipment is not waterproof. To prevent a fire or shock hazard, do not place any container filled with liquid near this equipment (such as a vase or flower pot) or expose it to dripping, splashing, rain or moisture.

D3-4-2-1-3_A_En

WARNING

Before plugging in for the first time, read the following section carefully.

The voltage of the available power supply differs according to country or region. Be sure that the power supply voltage of the area where this unit will be used meets the required voltage (e.g., 230V or 120V) written on the rear panel.

D3-4-2-1-4_A_En

WARNING

To prevent a fire hazard, do not place any naked flame sources (such as a lighted candle) on the equipment.

D3-4-2-1-7a_A_En

VENTILATION CAUTION

When installing this unit, make sure to leave space around the unit for ventilation to improve heat radiation (at least 10 cm at top, 10 cm at rear, and 10 cm at each side).

WARNING

Slots and openings in the cabinet are provided for ventilation to ensure reliable operation of the product, and to protect it from overheating. To prevent fire hazard, the openings should never be blocked or covered with items (such as newspapers, table-cloths, curtains) or by operating the equipment on thick carpet or a bed.

D3-4-2-1-7b_A_En

Operating Environment

Operating environment temperature and humidity:

+5 °C – +35 °C (+41 °F – +95 °F); less than 85 %RH (cooling vents not blocked)

Do not install this unit in a poorly ventilated area, or in locations exposed to high humidity or direct sunlight (or strong artificial light)

D3-4-2-1-7c_A_En

This product is intended for household purposes. Any failure due to use for other than household purposes (such as long-term use for business purposes in a restaurant or use in a car or ship) and which requires repair will be charged for even in the warranty period.

KO41_En

CAUTION

This product is a class 1 laser product, but this product contains a laser diode higher than Class 1. To ensure continued safety, do not remove any covers or attempt to gain access to the inside of the product. Refer all servicing to qualified personnel.

The following caution label appears on your unit.

Location: top of the unit



CAUTION : VISIBLE AND INVISIBLE LASER RADIATION WHEN OPEN. AVOID EXPOSURE TO BEAM.

VORSICHT : SICHTBARE UND UNSICHTBARE LASERSTRAHLUNG. WENNABDECKUNG GEÖFFNET NICHT DEM STRAHL AUSSETZEN!

ADVARSEL : SYNLIG OG USYNLIG LASERSTRÅLING VED ÅBNING UNGDÅ UDSÆTTELSE FOR STRÅLING.

VARNING : SYNLIG OCH OSYNLIG LASERSTRÅLNING NÄR DENNA DEL ÄR ÖPPNAD BETRÄKTA EJ STRÅLEN.

VARO! : AVATTAESSA ALTIKUT NÄKYVÄ JA NÄKYMÄTTÖMÄLLE LASERSATELI YLLE. ÄLÄ KATSO SÄTEESEEN.

CUIDADADO : RADIACIÓN LASER VISIBLE E INVISIBLE AL ESTAR ABIERTO. EVITAR EXPOSICIÓN AL RAYO.

VRW1872

D3-4-2-1-8_A_En

This product complies with the Low Voltage Directive (73/23/EEC, amended by 93/68/EEC), EMC Directives (89/336/EEC, amended by 92/31/EEC and 93/68/EEC).

D3-4-2-1-9a_En

If the AC plug of this unit does not match the AC outlet you want to use, the plug must be removed and appropriate one fitted. Replacement and mounting of an AC plug on the power supply cord of this unit should be performed only by qualified service personnel. If connected to an AC outlet, the cut-off plug can cause severe electrical shock. Make sure it is properly disposed of after removal. The equipment should be disconnected by removing the mains plug from the wall socket when left unused for a long period of time (for example, when on vacation).

D3-4-2-2-1a_A_En

DRM (digital rights management) copy protection is a technology designed to prevent unauthorized copying by restricting playback, etc. of material on devices other than the PC (or other WMA recording equipment) used to record it. For detailed information, please see the instruction manuals or help files that came with your PC and/or software.

For U.S. and Australia Model



C67-7-3_En

CAUTION

These speaker terminals carry **HAZARDOUS LIVE voltage**. To prevent the risk of electric shock when connecting or disconnecting the speaker cables, disconnect the power cord before touching any uninsulated parts.

D3-4-2-2-3_A_En

CAUTION

The **STANDBY/ON** switch on this unit will not completely shut off all power from the AC outlet. Since the power cord serves as the main disconnect device for the unit, you will need to unplug it from the AC outlet to shut down all power. Therefore, make sure the unit has been installed so that the power cord can be easily unplugged from the AC outlet in case of an accident. To avoid fire hazard, the power cord should also be unplugged from the AC outlet when left unused for a long period of time (for example, when on vacation).

D3-4-2-2-2a_A_En

POWER CORD CAUTION

Handle the power cord by the plug. Do not pull out the plug by tugging the cord and never touch the power cord when your hands are wet as this could cause a short circuit or electric shock. Do not place the unit, a piece of furniture, etc., on the power cord, or pinch the cord. Never make a knot in the cord or tie it with other cords. The power cords should be routed such that they are not likely to be stepped on. A damaged power cord can cause a fire or give you an electrical shock. Check the power cord once in a while. When you find it damaged, ask your nearest PIONEER authorized service center or your dealer for a replacement.

5002_En

Thank you for buying this Pioneer product.

Please read through these operating instructions so that you will know how to operate your model properly. After you have finished reading the instructions, put them in a safe place for future reference.

Contents

01 Getting started

Home theater sound setup	6
Setting the channel levels	6
Using the on-screen displays	7
Playing discs	7
Basic playback controls	7
Resume and Last Memory	8
DVD-Video disc menus	8
Video CD/Super VCD PBC menus	8
Listening to the radio	9
Improving poor FM reception	9
Memorizing stations	9
Listening to station presets	9
Listening to other sources	9
Setting the sleep timer	10
Dimming the display	10

02 Listening to your system

About the listening modes	11
Auto listening mode	11
Listening in surround sound	11
Using Front Surround	11
Listening in stereo	12
Listening with headphones	12
Using the SFC modes	12
Adjusting the bass and treble	12
Boosting the bass level	12

03 Playing discs

Scanning discs	13
Playing in slow motion	13
Frame advance/frame reverse	13
Playing a JPEG slideshow	13
Browsing DVD or Video CD/Super VCD discs with the Disc Navigator	14
Browsing WMA, MP3, DivX video and JPEG files with the Disc Navigator	14
Looping a section of a disc	15
Using repeat play	15

Using random play	16
Creating a program list	16
Other functions available from the program menu	17
Searching a disc	17
Switching subtitles	17
Switching language / audio channels	17
Zooming the screen	18
Switching camera angles	18
Displaying disc information	18

04 More tuner features: RDS

An introduction to RDS	19
Displaying RDS information	19
Searching for RDS programs	19

05 Audio Settings and Video Adjust menus

Audio Settings menu	20
Audio DRC	20
Video Adjust menu	20

06 Initial Settings menu

Using the Initial Settings menu	21
Video Output settings	21
Language settings	22
Display settings	22
Options settings	22
Speakers settings	23
Parental Lock	23
About DivX® VOD content	24
Speaker Distance	24

07 Other connections

Connecting auxiliary components	26
Recording mode	27
Connecting external antennas	27
Connecting the S-video output	27

Connecting using the component video output	28	Installation and maintenance	36
About progressive scan video	28	Hints on installation	36
Using the SCART AV output	29	Cleaning the pickup lens	36
		Problems with condensation	36
		Moving the system unit	36
08 Controls and displays		Screen sizes and disc formats	36
Display	30	TV system setting	37
Front panel	31	Frequency step setting	37
Remote control	31	Troubleshooting	38
		General	38
09 Additional information		DVD/CD/Video CD player	39
Disc / content format playback compatibility	33	Tuner	40
Disc compatibility table	33	Error Messages	40
About DivX	34	Resetting the system	40
DivX video compatibility	34	Using the language code list	40
About WMA	35	Language code list	41
Using and taking care of discs	35	Country/Area code list	41
DVD Video regions	35	Specifications	42
Handling discs	35		
Storing discs	35		
Discs to avoid	35		

Chapter 1

Getting started

Home theater sound setup

Depending on the size and characteristics of your room, you can place your speakers in one of two ways using this system:¹

- **Standard surround 5-spot setup** – This is a standard multichannel surround sound speaker setup for optimal 5.1 channel home theater sound.

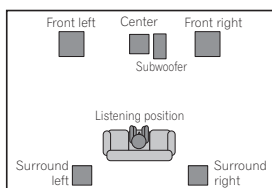

- **Front surround 3-spot setup** – This setup is ideal when rear surround speaker placement isn't possible or you want to avoid running long speaker cables in your listening area. Use this setup together with the Front Surround modes to take advantage of wall and ceiling reflections for a very realistic surround effect.

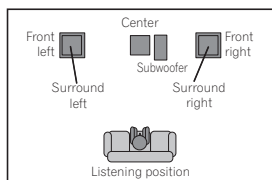

After placing your speakers, complete *Setting the channel levels* below then refer to *Speakers settings* on page 23 to complete your surround sound setup.

Setting the channel levels

Set the relative channel levels from your main listening position.²

1 Press **SHIFT+TEST TONE**.

The test tone is output in the following order (from the speakers active in the current listening mode):

- **L** – Front left speaker
- **C** – Center speaker
- **R** – Front right speaker
- **SR** – Right surround speaker
- **SL** – Left surround speaker
- **SW** – Subwoofer³

2 Use the **VOLUME +/-** button to adjust the volume to an appropriate level.

3 Use the **↑/↓** (cursor up/down) buttons to adjust the speaker levels in turn.

You should hear the test tone at the same volume from each speaker when seated in the main listening position. The channel level range is ± 10 dB.

4 When you're done, press **ENTER** to exit test tone setup.

Note

¹ See *About the listening modes* on page 11 for more on using the different listening modes with each speaker setup.

² This is only available when **DVD/CD** is selected and playback is stopped. Also make sure headphones are unplugged.

The speaker volume can be adjusted while listening to any sound source you want: Press **SHIFT+SYSTEM SETUP**, use the **←/→** (cursor left/right) buttons to select the channel level setting, then press **ENTER**. Use **↑/↓** (cursor up/down) to adjust the channel levels; **←/→** (cursor left/right) to move to the next channel. Press **ENTER** when you're finished.

³ Since the subwoofer produces ultra-low frequencies its sound may seem quieter than it actually is.

Using the on-screen displays

For ease of use, this system makes extensive use of graphical on-screen displays (OSDs).

All the screens are navigated in basically the same way, using the cursor buttons (↑, ↓, ←, →) to change the highlighted item and pressing **ENTER** to select it.¹

Important

- Throughout this manual, 'Select' means use the cursor buttons to highlight an item on-screen, then press **ENTER**.

Button	What it does
HOME MENU	Displays/exits the on-screen display
← ↑ ↓ →	Changes the highlighted menu item
ENTER	Selects the highlighted menu item
RETURN	Returns to the main menu without saving changes

Tip

- The button guide at the bottom of every OSD screen shows you which buttons you'll need to use for that screen.

Playing discs

The basic playback controls for playing DVD, CD, Video CD/Super VCD, DivX video and MP3/WMA discs are covered here. Further functions are detailed in chapter 3.

1 If the player isn't already on, switch it on.

If you're playing a disc with video, also turn on your TV and make sure that it is set to the correct video input.

2 Press **▲ OPEN/CLOSE** to load a disc.

Load a disc with the label side facing up, using the disc tray guide to align the disc (if you're loading a double-sided DVD disc, load it with the side you want to play face down).

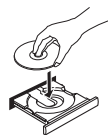

3 Press **▶ (play)** to start playback.

If you're playing a DVD or Video CD/Super VCD, a menu may appear. See *DVD-Video disc menus* and *Video CD/Super VCD PBC menus* on page 8 to navigate these.

If you're playing a DivX video or WMA/MP3 disc, it may take a few seconds before playing.

If you loaded a CD/CD-R/RW containing JPEGs, a slideshow will start. See *Playing a JPEG slideshow* on page 13 for more on this.

- If a disc contains a mixture of DivX video and other media file types (MP3, for example), first select whether to play the DivX video files (**DivX**) or the other media file types (**MP3 / WMA / JPEG**) from the on-screen display.

4 Adjust the volume.

Use the **VOLUME** control.

Basic playback controls

The following table shows the basic controls on the remote for playing discs². You can find other playback features in the chapter 3.

Button	What it does
▶	Starts/resumes normal playback. <ul style="list-style-type: none"> If the display shows RESUME or LAST MEM playback starts from the resume or last memory point (see <i>Resume and Last Memory</i> below).
 	Pauses/unpauses a disc.

Note

¹ The screen saver will appear after five minutes of inactivity.

² You may find with some DVD discs that some playback controls don't work in certain parts of the disc.

Button What it does

- Stops playback or cancels the resume function (if the display shows **RESUME**).

- ◀◀ Press to start fast reverse scanning.

- ▶▶ Press to start fast forward scanning.

- ◀◀ Skips to the start of the current track or chapter, then previous tracks/chapters.

- ▶▶ Skips to the next track or chapter.

Numbers Use to enter a title/chapter/track number. Press **ENTER** to select.

- If the disc is stopped, playback starts from the selected title (for DVD) or track (for CD/Video CD/Super VCD).
- If the disc is playing, playback jumps to the start of the selected title (VR mode DVD-RW), chapter (DVD-Video) or track (CD/Video CD/Super VCD).

Resume and Last Memory

When you stop playback of a disc, **RESUME** shows in the display indicating that you can resume playback from that point. With DVDs and Video CD/Super VCDs, even if ejected, the play position is stored in memory.¹ The next time you load the disc, the display shows **LAST MEM** and you can resume playback. If you want to clear the resume point, press ■ (stop) while **RESUME** is displayed.

DVD-Video disc menus

Many DVD-Video discs contain menus from which you can select what you want to watch.

Sometimes DVD-Video menus are displayed automatically when you start playback; others only appear when you press **DVD MENU** or **TOP MENU**.

Button What it does

- SHIFT+TOP MENU** Displays the 'top menu' of a DVD disc—this varies with the disc.

- DVD MENU** Displays a DVD disc menu—this varies with the disc and may be the same as the 'top menu'.

- ←↑↓→ Moves the cursor around the screen.

- ENTER** Selects the current menu option.

- RETURN** Returns to the previously displayed menu screen.

- Numbers** Highlights a numbered menu option (some discs only). Press **ENTER** to select.

Video CD/Super VCD PBC menus

Some Video CD/Super VCDs have menus from which you can choose what you want to watch. These are PBC (Playback control) menus. You can play a PBC Video CD/Super VCD without having to navigate the PBC menu by starting playback using a number button to select a track, rather than the ▶ (play) button.

Button What it does

- RETURN** Displays the PBC menu.

- Numbers** Selects numbered menu options. Press **ENTER** to select.

- ◀◀ Displays the previous menu page (if there is one).

- ▶▶ Displays the next menu page (if there is one).

Note

- 1 • The Last Memory function may not work with some discs.
- For DVD-Video discs (except VR mode DVD-RW), the player stores the play position of the last five discs.

Listening to the radio

The tuner can receive both FM and AM broadcasts, and lets you memorize your favorite stations so you don't have to manually tune in every time you want to listen.

U.K. model only – See also *More tuner features*: RDS on page 19.

1 Press TUNER to switch to the tuner, then press repeatedly to select the AM or FM band.
The display shows the band and frequency.

2 Tune to a frequency.

There are three tuning modes—manual, auto, and high-speed:

- **Manual tuning:** Press **TUNE +/-** repeatedly to change the displayed frequency.
- **Auto tuning:** Press and hold **TUNE +/-** until the frequency display starts to move, then release. The tuner will stop on the next station it finds. Repeat to keep searching.
- **High-speed tuning:** Press and hold **TUNE +/-** until the frequency display starts to move rapidly. Keep the button held down until you reach the frequency you want. If necessary, fine tune the frequency using the manual tuning method.

Improving poor FM reception

If you're listening to an FM station in stereo but the reception is weak, you can improve the sound quality by switching to mono.

1 Tune to an FM radio station then press SHIFT+SYSTEM SETUP.

2 Use ←/→ (cursor left/right) to choose FM MODE then press ENTER.

3 Use ↑/↓ (cursor up/down) to select FM MONO then press ENTER.

The mono indicator (○) lights when the tuner is in mono reception mode.

Select **FM AUTO** above to switch back to auto-stereo mode (the stereo indicator (⊕) lights when receiving a stereo broadcast).

Memorizing stations

You can save up to 30 station presets so that you always have easy access to your favorite stations without having to tune in manually each time.

1 Tune to an AM or FM radio station.

For the FM band, select mono or auto-stereo reception as necessary. This setting is saved along with the preset.

2 Press SHIFT+SYSTEM SETUP.

3 Use ←/→ (cursor left/right) to choose 'ST.MEM.' then press ENTER.

4 Use ↑/↓ (cursor up/down) to select the station preset you want then press ENTER.

Listening to station presets

1 Make sure the TUNER function is selected.

2 Use the ST +/- buttons to select a station preset.

- You can also use the number buttons to do this.

Listening to other sources

You can connect up to two external sources (TV, satellite receiver, etc.) to this system. See *Connecting auxiliary components* on page 26.



1 Make sure that the external source (TV, satellite receiver, etc.) is switched on.

2 Press LINE to select the source.

Press repeatedly to switch between **LINE1** and **LINE2**.

3 If necessary, start playback of the source.

Setting the sleep timer

The sleep timer switches off the system after a specified time so you can fall asleep without worrying about it.¹

• **Press SLEEP repeatedly to select an option then press ENTER.**

Choose between the following options:²

- **SLP AUTO** – Switches off automatically after the currently playing CD, Video CD or DivX disc has finished.
- **SLP ON** – Switches off after about an hour
- **SLP OFF** – Cancels the sleep timer

After selecting **SLP ON**, you can press **SLEEP** again to check how much time is left. Each line indicates approximately 12 minutes (remaining):



Dimming the display

You can choose to dim the display if you find it too bright.

1 Press SHIFT+SYSTEM SETUP.

2 Use ←/→ (cursor left/right) then ENTER to choose the dimmer setting.

This is shown in the front panel display.

3 Use ↑/↓ (cursor up/down) to select LIGHT or DARK then press ENTER.

Note

¹ The display dims when the sleep timer is set.

² **Sleep Auto** will not work with WMA/MP3 discs, Video CD/Super VCDs during PBC playback, or CDs in repeat play.

Chapter 2

Listening to your system

About the listening modes

As explained in *Home theater sound setup* on page 6, there are two basic surround speaker setup options available with any of the listening modes:

- **Standard surround 5-spot setup** – Use any of the surround listening modes with this setup (except Front Surround).
- **Front surround 3-spot setup** – Make sure the Front Surround mode is switched on before selecting a surround listening mode (see *Using Front Surround* on page 11).

Auto listening mode

The Auto listening mode is the simplest way to listen to any source as it was mastered: the output from the speakers mirrors the channels in the source material.



- Press **SHIFT+SURROUND** to select the **AUTO** listening mode.¹

Listening in surround sound

You can listen to stereo or multichannel sources in surround sound.² Surround sound is generated from stereo sources using one of the Dolby Pro Logic decoding modes.



Note

¹ If the source is Dolby Digital or DTS, the front panel **D** or **DTS** indicator lights.

² • Note that the input source must be switched to **DVD/CD** for multichannel playback.

• If you're planning on recording a multichannel source, refer to *Recording mode* on page 27.

³ When listening in **DOLBY DIGITAL / DTS** mode, two-channel material will automatically be played in surround sound using Dolby Pro Logic II decoding.

- Press **SHIFT+SURROUND** repeatedly to select a listening mode.¹

The choices that appear in the display will vary according to the type of source that's playing.

- **AUTO** – Auto listening mode (see above)
- **DOLBY DIGITAL / DTS** – Dolby Digital or DTS decoding (depending on the source).³ For a multichannel source, this will be the same as **AUTO**.
- **PROLOGIC** – 4.1 channel surround sound for use with any two-channel source
- **MOVIE** – Pro Logic II 5.1 channel surround sound, especially suited to movie sources (use with any two-channel source)
- **MUSIC** – Pro Logic II 5.1 channel surround sound, especially suited to music sources, for use with any two-channel source
- **STEREO** – See *Listening in stereo* below

Using Front Surround

The Front Surround mode is effective when you are using the Front surround 3-spot speaker setup as described in *Home theater sound setup* on page 6. The surround speakers should be placed on top of the front speakers and oriented towards the walls (see the *Speaker Setup Guide*) and **DVD/CD** must be selected as the input source.²



- Press **SHIFT+FRONT SURROUND** to switch Front Surround on or off.

When set to **MODE ON**, make sure to follow the guidelines in the Setup Guide for best surround sound.

Listening in stereo

You can listen to any source—stereo or multichannel—in stereo. When playing a multichannel source, all channels are downmixed to the front left/right speakers and the subwoofer.



- Press **SHIFT+SURROUND** repeatedly until **STEREO** shows in the display.

Listening with headphones

When headphones are connected, only the **STEREO** mode is available.

Using the SFC modes

The SFC (Sound Field Control) modes can be used with any multichannel or stereo source for a variety of additional surround sound effects.



- 1 Press **SOUND MODE**.
- 2 Use **←/→** (cursor left/right) to select **SFC MODE** then press **ENTER**.
- 3 Press **↑/↓** (cursor up/down) then **ENTER** to select an SFC Sound Mode. Select between **OFF**, **ACTION**, **DRAMA**, **ROCK**, **POP**, **HALL** or **LIVE**.

Adjusting the bass and treble

Use the bass and treble controls to adjust the overall tone.

- 1 Press **SOUND MODE**.
- 2 Use **←/→** (cursor left/right) to select **BASS** or **TREBLE** then press **ENTER**.
- 3 Use **↑/↓** (cursor up/down) to adjust the sound then press **ENTER** to confirm.

Boosting the bass level

There are two bass modes you can use to enhance the bass in a source.

- 1 Press **SOUND MODE**.
- 2 Use **←/→** (cursor left/right) to select **BASSMODE** then press **ENTER**.
- 3 Use **↑/↓** (cursor up/down) to adjust the sound then press **ENTER** to confirm. Select between **OFF**, **MUSIC** or **CINEMA**.

Chapter 3

Playing discs



Important

- Many of the functions covered in this chapter apply to DVD discs, Video CDs/Super VCDs, CDs, DivX video and WMA/MP3/JPEG discs, although the exact operation of some varies slightly with the kind of disc loaded.
- Some DVDs restrict the use of some functions (random or repeat, for example) in some or all parts of the disc. This is not a malfunction.
- When playing Video CD/Super VCDs, some of the functions are not available during PBC playback. If you want to use them, start the disc playing using a number button to select a track.

Scanning discs

You can fast-scan discs forward or backward at various different speeds.¹

- **During playback, press ◀◀ or ▶▶ to start scanning.**

Press repeatedly to increase the scanning speed (shown on-screen).

- To resume playback, press ▶ (play).²

Playing in slow motion

You can play DVDs, Video CD/Super VCDs and DivX video at four different forward slow motion speeds. DVD discs can also be played in reverse slow motion.

Note

¹ Only one speed is available for DivX video discs.

² Depending on the disc, normal playback may automatically resume when a new chapter is reached on a DVD disc.

• With Video CD/Super VCDs in PBC mode or a WMA/MP3 track, playback automatically resumes at the end or beginning of the track.

³ The time it takes for the player to load a file increases with large file sizes.

• Discs can contain up to 299 folders and up to 648 folders and files combined.

- 1 **During playback, press II (pause).**

- 2 **Press and hold ◀I/◀II or II/I▶ until slow motion playback starts.**

Press repeatedly to change the slow motion speed (shown on-screen).

- To resume playback, press ▶ (play).²

Frame advance/frame reverse

You can advance or back up DVD discs frame-by-frame. With Video CD/Super VCDs and DivX video you can only use frame advance.

- 1 **During playback, press II (pause).**

- 2 **Press ◀I/◀II or II/I▶ to reverse or advance a frame at a time.**

- To resume playback, press ▶ (play).²

Playing a JPEG slideshow

After loading a CD/CD-R/RW containing JPEG pictures, press ▶ to start a slideshow from the first folder/picture on the disc.³ The player displays the pictures in each folder in alphabetical order.

Pictures are automatically adjusted so that they fill as much of the screen as possible.

While the slideshow is running:

Button	What it does
II	Pauses the slideshow; press again to restart.

Button	What it does
◀◀	Displays the previous picture.
▶▶	Displays the next picture.
◀/▶/↑/↓	Pauses the slideshow and rotates/flips the displayed picture. (Press ▶ (play) to restart slideshow).
ZOOM	Pauses the slideshow and zooms the picture. Press again to toggle between 1x, 2x and 4x zoom. (Press ▶ (play) to restart slideshow).
DVD MENU	Displays the Disc Navigator screen (see below).

Browsing DVD or Video CD/ Super VCD discs with the Disc Navigator

Use the Disc Navigator to browse through the contents of a DVD or Video CD/Super VCD disc to find the part you want to play.

1 During playback, press HOME MENU and select 'Disc Navigator' from the on-screen menu.

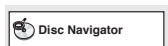

2 Select a view option.

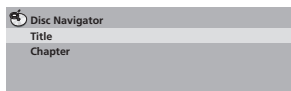

The options available depend on the kind of disc loaded and whether the disc is playing or not, but include:

- **Title** – Titles from a DVD-Video disc.
- **Chapter** – Chapters from the current title of a DVD-Video disc.

- **Track** – Tracks from a Video CD/Super VCD disc.
- **Time** – Thumbnails from a Video CD/Super VCD disc at 10 minute intervals.
- **Original: Title** – Original titles from a VR mode DVD-RW disc.
- **Playlist: Title** – Playlist titles from a VR mode DVD-RW disc.
- **Original: Time** – Thumbnails from the Original content at 10 minute intervals.
- **Playlist: Time** – Thumbnails from the Playlist at 10 minute intervals.

The screen shows up to six moving thumbnail images displayed one after another. To display the previous/next six thumbnails, press ◀◀/▶▶.

3 Select the thumbnail image for what you want to play.

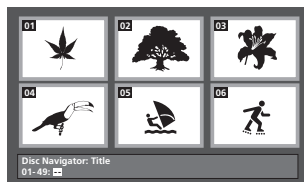

You can use either the cursor buttons (↑/↓/◀/▶) and **ENTER** to select a thumbnail, or the number buttons.

To select using the number buttons, enter a two-digit number then press **ENTER**.

Browsing WMA, MP3, DivX video and JPEG files with the Disc Navigator

Use the Disc Navigator to find a particular file or folder by filename.

1 Press HOME MENU and select 'Disc Navigator' from the on-screen menu.

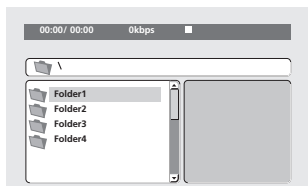

2 Use the cursor buttons (↑/↓/←/→) and ENTER to navigate.

Use the cursor up/down buttons (↑/↓) to move up and down the folder/file list. Use the cursor left button (←) to return to the parent folder.¹

Use **ENTER** or cursor right (→) to open a highlighted folder.

- When a JPEG file is highlighted, a thumbnail image is displayed on the right.

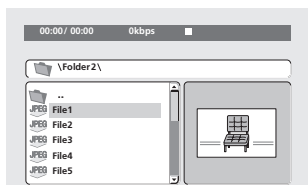

3 To play the highlighted track or DivX video file or display the highlighted JPEG file, press ENTER.

- When a WMA/MP3 or DivX video file is selected, playback begins from that file, and continues until the end of the folder.
- When a JPEG file is selected, a slideshow begins, starting with that file, and continues to the end of the folder.



Tip

- To play the contents of the whole disc rather than just the current folder, exit the Disc Navigator and start playback using the ► (play) button.

Looping a section of a disc

The A-B Repeat function allows you to specify two points (A and B) within a track (CD, Video CD/Super Video CD) or title (DVD) that form a loop which is played over and over.

1 During playback, press HOME MENU and select 'Play Mode'.



2 Select 'A-B Repeat'.

3 Press ENTER on 'A(Start Point)' to set the loop start point.

4 Press ENTER on 'B(End Point)' to set the loop end point.

After pressing **ENTER**, playback jumps back to the start point and plays the loop.

5 To resume normal playback, select 'Off'.

Using repeat play

In addition to various repeat play options, it's also possible to use repeat play together with program play (see *Creating a program list* on page 16).

1 During playback, press HOME MENU and select 'Play Mode'.

2 Select 'Repeat' then select a repeat play option.²

If program play is active, select **Program Repeat** to repeat the program list, or **Repeat Off** to cancel.

Note

¹ You can also do this by going to the '..' folder at the top, then pressing **ENTER**.

² You can't use repeat play with WMA/MP3 discs.

- For DVD discs, select **Title Repeat** or **Chapter Repeat**.
- For CDs and Video CD/Super VCDs, select **Disc Repeat** or **Track Repeat**.
- For DivX video discs, select **Repeat Title** (or **Repeat Off**).

Using random play

Use this function to play titles or chapters (DVD-Video) or tracks (CD and Video CD/Super VCD) in a random order.¹

1 During playback, press HOME MENU and select 'Play Mode'.

2 Select 'Random' then select an option.

- For DVD discs, select **Random Title** or **Random Chapter**.
- For CDs and Video CD/Super VCDs, select **On** or **Off** to switch random play on or off.



Tip

- Use the following controls during random play:

Button	What it does
▶▶	Selects a new track/title/chapter at random.
◀◀	Returns to the beginning of the current track/title/chapter; further presses select another random track/title/chapter.

- Random play remains in effect until you select **Random Off** from the random play menu options.

Note

- You can set the random play option when a disc is playing or stopped. However, you can't use random play together with program play.
 - You can't use random play with VR format DVD-RW discs, WMA/MP3 discs, DivX video discs, or while a DVD disc menu is being displayed.
- Program lists are saved for the DVD disc loaded. When you load a disc with a saved program list, program play is automatically turned on.
 - You can't use Program play with VR format DVD-RW discs, WMA/MP3 discs, DivX video discs, or while a DVD disc menu is being displayed.

Creating a program list

This feature lets you program the play order of titles/chapters/tracks on a disc.²

1 During playback, press HOME MENU and select 'Play Mode'.

2 Select 'Program' then select 'Create/Edit' from the list of program options.

3 Use the cursor buttons and ENTER to select a title, chapter or track for the current step in the program list.

For a DVD disc, you can add a title or a chapter.

- For a CD or Video CD/Super VCD, select a track to add to the program list.

After pressing **ENTER** to select the title/chapter/track, the step number automatically moves down one.

4 Repeat step 3 to build up a program list.

A program list can contain up to 24 steps.

- You can insert steps by just highlighting the position where you want the new step to appear and entering a title/chapter/track number.
- To delete a step, highlight it and press **CLEAR**.

5 To play the program list, press ▶ (play).

Program play remains active until you turn off program play (see below), erase the program list (see below), eject the disc or switch off.

**Tip**

- Use the following controls during program play:

Button	What it does
HOME MENU	Save the program list and exit without starting playback.
▶▶	Skip to the next step in the program list.

Other functions available from the program menu

There are a number of other options in the program menu in addition to Create/Edit.

- **Playback Start** – Starts playback of a saved program list
- **Playback Stop** – Turns off program play, but does not erase the program list
- **Program Delete** – Erases the program list and turns off program play

Searching a disc

You can search DVD discs by title or chapter number, or by time; CDs and Video CD/Super VCDs by track number or time; DivX video discs by time.

1 Press HOME MENU and select 'Play Mode'.

2 Select 'Search Mode'.

The search options that appear depend on the kind of disc loaded.

3 Select a search mode.

- The disc must be playing in order to use time search.

4 Use the number buttons to enter a title, chapter or track number, or a time.

- For a time search, enter the number of minutes and seconds into the currently playing title (DVD/ DivX video) or track (CD/ Video CD/Super VCD) you want playback to resume from. For example, press **4, 5, 0, 0** to have playback start from 45 minutes into the disc. For 1 hour, 20 minutes and 30 seconds, press **8, 0, 3, 0**.

5 Press ENTER to start playback.

Switching subtitles

Some DVD discs and DivX video discs have subtitles in one or more languages; the disc box will usually tell you which subtitle languages are available. You can switch subtitle language during playback.¹

• Press SHIFT+SUBTITLE repeatedly to select a subtitle option.

- To set subtitle preferences, see *Language settings* on page 22.
- See *Displaying DivX subtitle files* on page 34 for more on DivX subtitles.

Switching language / audio channels

When playing discs recorded with dialog in two or more languages, or with dual-mono audio² you can switch these during playback.³

• Press SHIFT+AUDIO repeatedly to select an audio language option.

- To set audio language preferences, see *Language settings* on page 22.

Note

¹ Some discs only allow you to change subtitle language from the disc menu. Press **SHIFT+TOP MENU** or **DVD MENU** to access.

² Some Super VCDs have two soundtracks. With these discs you can switch between the two soundtracks as well as individual channels in each.

³ Some discs only allow you to change audio language from the disc menu. Press **SHIFT+TOP MENU** or **DVD MENU** to access.

Zooming the screen

Using the zoom feature you can magnify a part of the screen by a factor of 2 or 4, while watching a DVD, DivX video title or Video CD/Super VCD or playing a JPEG disc.

1 During playback, use the SHIFT+ZOOM button to select the zoom factor (Normal, 2x or 4x).

2 Use the cursor buttons to change the zoomed area.

You can change the zoom factor and the zoomed area freely during playback.¹

Switching camera angles

Some DVD discs feature scenes shot from two or more angles—check the disc box for details.

When a multi-angle scene is playing, a  icon appears on screen (this can be switched off if you prefer—see *Display settings* on page 22).

- **During playback (or when paused), press SHIFT+ANGLE to switch angle.**

Displaying disc information

Various track, chapter and title information can be displayed on-screen during playback.

- **To show/switch/hide the information displayed, press DISPLAY repeatedly.**

Limited disc information also appears in the front panel display. Press **DISPLAY** to change the displayed information.

Note

¹ • Since DVD, Video CD/Super VCD, DivX video title and JPEG pictures have a fixed resolution, picture quality will deteriorate, especially at 4x zoom. This is not a malfunction.

- If the navigation square at the top of the screen disappears, press **SHIFT+ZOOM** again to display it.

Chapter 4

More tuner features: RDS

U.K. model only

An introduction to RDS

Radio Data System (RDS) is a system used by most FM radio stations to provide listeners with various kinds of information—the name of the station and the kind of show they're broadcasting, for example.

One feature of RDS is that you can search by type of program. For example, you can search for a station that's broadcasting a show with the program type, **JAZZ**.

You can search the following program types:¹

NEWS – News	FINANCE – Stock market reports, commerce, trading, etc.
AFFAIRS – Current Affairs	CHILDREN – Programs for children
INFO – General Information	SOCIAL – Social affairs
SPORT – Sport	RELIGION – Programs concerning religion
EDUCATE – Educational	PHONE IN – Public expressing their views by phone
DRAMA – Radio plays, etc.	TRAVEL – Holiday-type travel rather than traffic announcements
CULTURE – National or regional culture, theater, etc.	LEISURE – Leisure interests and hobbies
SCIENCE – Science and technology	JAZZ – Jazz
VARIED – Usually talk-based material, such as quiz shows or interviews.	COUNTRY – Country music
POP M – Pop music	NATION M – Popular music in a language other than English
ROCK M – Rock music	OLDIES – Popular music from the '50s and '60s
EASY M – Easy listening	FOLK M – Folk music
LIGHT M – 'Light' classical music	DOCUMENT – Documentary
CLASSICS – 'Serious' classical music	
OTHER M – Music not fitting above categories	
WEATHER – Weather reports	

Displaying RDS information

Use the **DISPLAY** button to display the different types of RDS information available.²

- **Press DISPLAY for RDS information.**

Each press changes the display as follows:

- Radio Text (**RT**) – Messages sent by the radio station. For example, a talk radio station may provide a phone number as RT.
- Program Service Name (**PS**) – The name of the radio station.
- Program Type (**PTY**) – This indicates the kind of program currently being broadcast.
- **SEARCH** – PTY search (see below)
- Current tuner frequency

Searching for RDS programs

You can search for a program type listed above.

- 1 **Press the TUNER button for the FM band.**³
- 2 **Press DISPLAY repeatedly until SEARCH appears in the display.**
- 3 **Use ←/→ (cursor left/right) to select the program type you want to hear.**
- 4 **Press ENTER to start the search.**
The system searches the station presets for a match. If it finds one, searching stops for 5 sec.
- 5 **If you want to keep listening to the station, press ENTER within the 5 seconds.**
If you don't press **ENTER**, searching resumes.

 **Note**

¹ In addition, there are three other program types, **TEST**, **ALARM**, and **NONE**. **ALARM** and **TEST** are used for emergency announcements. You can't search for these, but the tuner will switch automatically to this RDS broadcast signal. **NONE** appears when a program type cannot be found.

² • If any noise is picked up while displaying the RT scroll, some characters may be displayed incorrectly.

• If you see **NO RADIO TEXT DATA** in the RT display, it means no RT data is sent from the broadcast station. The display will automatically switch to the PS data display (if no PS data, the frequency is displayed).

• In the PTY display, **NO DATA** or **NONE** may be shown. In this case, the PS display is shown after a few seconds.

³ RDS is only possible in the FM band.

Chapter 5

Audio Settings and Video Adjust menus

Audio Settings menu

The Audio Settings menu offers features for adjusting the way discs sound.

1 Press **HOME MENU** and select 'Audio Settings' from the on-screen display.



2 Select and change settings using the **↑/↓/←/→** (cursor) buttons, and **ENTER**.

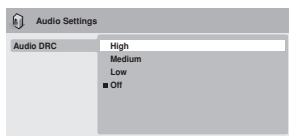

Audio DRC

- Settings: **High**, **Medium**, **Low**, **Off** (default)

When watching Dolby Digital DVDs at low volume, it's easy to lose the quieter sounds completely—including some of the dialog. Switching Audio DRC (Dynamic Range Control) to on can help by bringing up the quieter sounds, while controlling loud peaks.

How much of a difference you hear depends on the material you're listening to. If the material doesn't have wide variations in volume, you may not notice much change.¹

Video Adjust menu

From the Video Adjust screen you can adjust settings that affect picture presentation.

1 Press **HOME MENU** and select 'Video Adjust' from the on-screen display.



2 Make settings using the **↑/↓/←/→** (cursor) buttons, and **ENTER**.

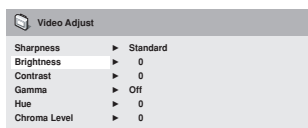

You can adjust the following settings:

- **Sharpness** – Adjusts the sharpness of edges in the picture (**Fine**, **Standard**, **Soft**)
- **Brightness** – Adjusts the overall brightness (**-20** to **+20**)
- **Contrast** – Adjusts the contrast between light and dark (**-16** to **+16**)
- **Gamma** – Adjusts the 'warmth' of the picture (**High**, **Medium**, **Low**, **Off**)
- **Hue** – Adjusts the red/green balance (**Green 9** to **Red 9**)
- **Chroma Level** – Adjusts how saturated colors appear (**-9** to **+9**)

Adjust the Brightness, Contrast, Hue and Chroma Level settings using the **←/→** (cursor left/right) buttons.



3 Press **ENTER** to return to the Video Adjust screen, or **HOME MENU** to exit.

Note

- ¹ • Audio DRC is only effective with Dolby Digital audio sources.

Chapter 6

Initial Settings menu

Using the Initial Settings menu

The Initial Settings menu provides audio and video output settings, parental lock settings, and display settings, among others.

If an option is grayed out it means that it cannot be changed at the current time. This is usually because a disc is playing. Stop the disc, then change the setting.

- 1 Press **HOME MENU** and select 'Initial Settings'.



- 2 Use the cursor buttons and **ENTER** to select the setting and option you want to set. All the settings and options are explained on the following pages.¹

Video Output settings

Setting	Option	What it means
TV Screen <i>(See also Screen sizes and disc formats on page 36.)</i>	4:3 (Letter Box)	Set if you have a conventional 4:3 TV. Widescreen movies are shown with black bars top and bottom.
	<i>4:3 (Pan & Scan)</i>	Set if you have a conventional 4:3 TV. Widescreen movies are shown with the sides cropped so that the image fills the screen.
	<i>16:9 (Wide)</i>	Set if you have a widescreen TV.
AV Connector Out <i>U.K. model only (See Using the SCART AV output on page 29.)</i>	Video	Standard video, compatible with all TVs.
	<i>S-Video</i>	Higher quality, but check your TV for compatibility.
	<i>RGB</i>	Best quality, but check your TV for compatibility.
Component Out <i>Australian model only (See also Connecting using the component video output on page 28.)</i>	Interlace	Set if your TV is not compatible with progressive scan video.
	<i>Progressive</i>	Set if your TV is compatible with progressive scan video (see your TV's instruction manual for details). Press ENTER once more to confirm (or RETURN to cancel). <i>Note that progressive scan video is only output from the component video jacks.</i>
S-Video Out <i>Australian model only (See also Connecting the S-video output on page 27.)</i>	S2	Standard setting.

Note

¹ In the table, the default setting is shown in **bold**; other settings are shown in *italics*.

• Some settings, such as **TV Screen**, **Audio Language** and **Subtitle Language** may be overridden by the DVD disc. Often these settings can also be made from the DVD disc menu.

• *U.K. model only* – The **AV Connector Out** setting only needs to be set if you have connected this player to your TV using a SCART cable.

Language settings

Setting	Option	What it means
Audio Language	English	If there is an English soundtrack on the disc, it is played.
	<i>Languages as displayed</i>	If there is a language selected on the disc, it is played.
	<i>Other Language</i>	Select to choose a language other than the ones displayed (see <i>Using the language code list</i> on page 40).
Subtitle Language	English	If there are English subtitles on the disc they are displayed.
	<i>Languages as displayed</i>	The subtitle language selected on the disc is displayed.
	<i>Other Language</i>	Select to choose a language other than the ones displayed (see <i>Using the language code list</i> on page 40).
DVD Menu Language	w/Subtitle Lang.	DVD disc menus are displayed in the same language as your selected subtitle language, if possible.
	<i>Languages as displayed</i>	DVD menus are displayed in the selected language, if possible.
	<i>Other Language</i>	Select to choose a language other than the ones displayed (see <i>Using the language code list</i> on page 40).
Subtitle Display	On	Subtitles are displayed in your selected subtitle language.
	Off	Subtitles are always off by default when you play a DVD disc.

Display settings

Setting	Option	What it means
OSD Language	English	On-screen displays of the player are in English.
	<i>Languages as displayed</i>	On-screen displays are shown in the language selected.
Angle Indicator	On	A camera icon is displayed on-screen during multi-angle scenes on a DVD disc.
	Off	No multi-angle indication is shown.

Options settings

Setting	Option	What it means
Parental Lock	–	See <i>Parental Lock</i> below.
DivX VOD	Display	See <i>About DivX® VOD content</i> below.

Speakers settings

Setting	Option	What it means
Speaker Distance	–	Specify the distance of your speakers from your listening position (see <i>Speaker Distance</i> on page 24).

Parental Lock

- Default level: **Off**; Default password: *none*;
Default Country code: **us (2119)**

To give you some control over what your children watch on your DVD player, some DVD-Video discs feature a Parental Lock level. If your player is set to a lower level than the disc, the disc won't play.

Some discs also support the Country Code feature. The player does not play certain scenes on these discs, depending on the Country Code you set.

Registering a new password

Register a password to change the Parental Lock level or enter a Country code.¹

1 Select 'Password'.

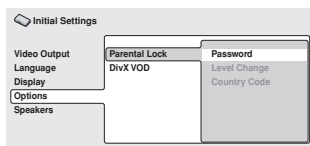

2 Use the number buttons to input a 4-digit password then press ENTER.

Changing your password

To change your password, confirm your existing password then enter a new one.

1 Select 'Password Change'.

2 Input your existing password, then press ENTER.

3 Enter a new password and press ENTER.

Setting/changing the Parental Lock

1 Select 'Level Change'.

2 Use number buttons to enter your password, then press ENTER.

3 Select a new level and press ENTER.

- Press ← (cursor left) repeatedly to lock more levels (more discs will require the password); press → (cursor right) to unlock levels. You can't lock level 1.

Setting/changing the Country code

You can find the *Country/Area code list* on page 41.

1 Select 'Country Code'.

2 Input your password, then press ENTER.

3 Select a Country code then press ENTER.

There are two ways you can do this:

- Select by code letter: Use ↑/↓ (cursor up/down) to change the Country code.
- Select by code number: Press → (cursor right) then use the number buttons to enter the 4-digit Country code.

The new Country code takes effect after ejecting the disc once.

Note

- Not all discs use Parental Lock, and will play without requiring the password first.
 - If you forget your password, you'll need to reset the player to register a new password. (see *Resetting the system* on page 40).

About DivX® VOD content

In order to play DivX VOD (video on demand) content on this player, you first need to register the player with your DivX VOD content provider. You do this by generating a DivX VOD registration code, which you submit to your provider.¹



Important

- DivX VOD content is protected by a DRM (Digital Rights Management) system. This restricts playback of content to specific, registered devices.
- If you load a disc that contains DivX VOD content not authorized for your player, the message **Authorization Error** is displayed and the content will not play.

Displaying your DivX VOD registration code

- 1 Press **HOME MENU** and select 'Initial Settings'.
- 2 Select 'Options', then 'DivX VOD'.

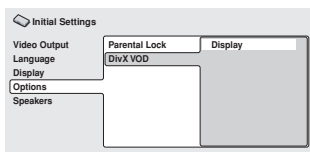

3 Select 'Display'.

Your 8-digit registration code is displayed.

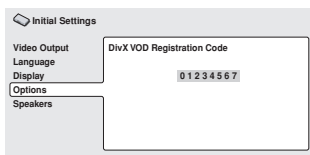

Make a note of the code as you will need it when you register with a DivX VOD provider.

Playing DivX® VOD content

Some DivX VOD content may only be playable a fixed number of times. When you load a disc containing this type of DivX VOD content, the remaining number of plays is shown on-screen and you then have the option of playing the disc (thereby using up one of the remaining plays), or stopping. If you load a disc that contains expired DivX VOD content (for example, content that has zero remaining plays), the message **Rental Expired** is displayed.

If your DivX VOD content allows an unlimited number of plays, then you may load the disc into your player and play the content as often as you like, and no message will be displayed.

Speaker Distance

- Default setting: **3.0 m**

To get the best surround sound from your system, you should set up the speaker distances from your listening position.

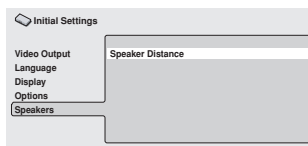

1 Use the ↑/↓ (cursor up/down) to select a speaker.

- The **L** and **R** speakers are paired; you can't set them differently.

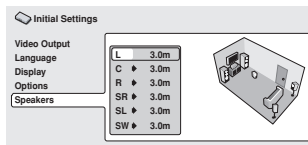

Note

¹ Resetting the player (as described in *Resetting the system* on page 40) will not cause you to lose your registration code.

2 Press → (cursor right) to change the speaker distance for the highlighted speaker.

3 Use the ↑/↓ (cursor up/down) to change the distance.

- When you change the distance settings of the front left (**L**) or front right (**R**) speakers, all the other speaker distances change relative to it.
- Front left/right (**L/R**) speaker distances can be set from 30 cm to 9 m in 30 cm increments.
- The center speaker (**C**) can be set from -2.1 m to 0 m relative to the front left/right speakers.
- Surround left/right (**SL/SR**) speakers can be set from -6.0 m to 0 m relative to the front left/right speakers.¹
- The subwoofer (**SW**) can be set from -2.1 m to 0 m relative to the front left/right speakers.

4 Press ← (cursor left) to go back to the speaker list if you want to modify another speaker, or press ENTER to exit the Speaker Distance screen.

 **Note**

¹ Make sure to set them the same distance when using Front Surround (page 11).

Chapter 7

Other connections

Connecting auxiliary components

U.K. model connections:

Using the stereo analog inputs, you can connect an external component such as a VCR, MD or CD player for playback through this system.

- **Connect the LINE 2 (AUDIO IN) jacks to the analog outputs of an external playback component.**

Connect using RCA pin-plug stereo cables.

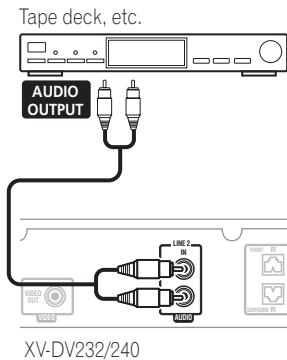
**Australian model connections:**

This system has both stereo analog inputs and outputs. Use these to connect external components, such as your VCR, MD or CD-R recorder.

- 1 Connect the LINE (AUDIO IN) jacks to the analog outputs of an external playback component.**

Connect using RCA pin-plug stereo cables.

- 2 Connect the LINE (AUDIO OUT) jacks to the analog inputs of an external recording component.**

These include components such as a cassette deck, VCR, MD, or another recorder with analog inputs. Connect using RCA pin-plug stereo cables.

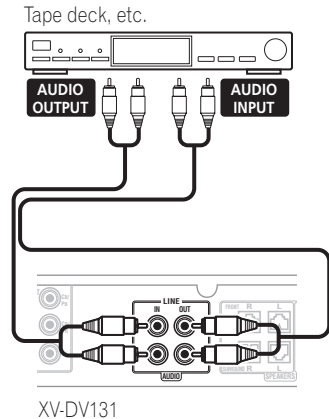

Recording mode

The Recording mode allows you to make surround-compatible analog recordings from the **LINE (AUDIO OUT)** jacks.¹ Dolby multichannel sources will be downmixed to stereo for improved playback with systems that can provide matrix-decoding (like Dolby Pro Logic).

1 Press **SOUND MODE**.

2 Use **←/→** (cursor left/right) to select **REC MODE** then press **ENTER**.

3 Use **↑/↓** (cursor up/down) to select **MODE ON** or **MODE OFF** then press **ENTER** to confirm.

- **MODE ON** – Multichannel sources are downmixed to stereo for recording (the same downmix is heard through the front speakers and the subwoofer).
- **MODE OFF** – For regular multichannel playback through your speaker system (only the front left and right channels are output from the line output).

Connecting external antennas

For an external AM antenna, use 5–6 meters of vinyl-insulated wire and set up either indoors or outdoors. Leave the loop antenna connected.

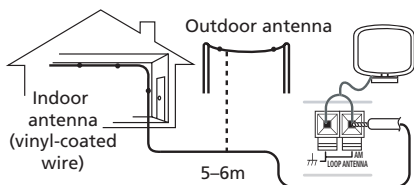

For an external FM antenna, Use a PAL connector to hook up an external FM antenna.

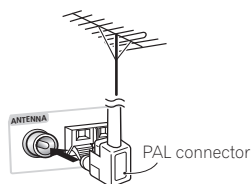

Connecting the S-video output

Australian model only

If your TV has an S-video input, you can use this instead of the standard video output for a better quality picture.

- Use an S-video cable to connect the **S-VIDEO OUT** to an **S-video input** on your TV. Line up the small triangle above the jack with the same mark on the plug before plugging in.

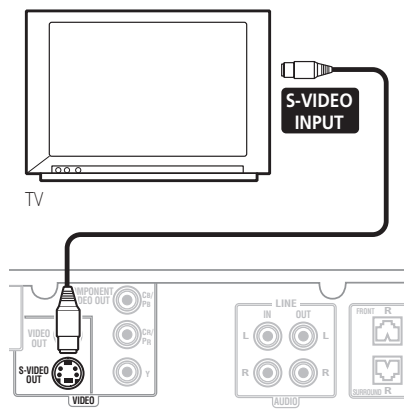

XV-DV131

Note

- When Recording mode is on, most sound features cannot be used. The display will briefly blink **REC MODE** if you try and use a prohibited function while Recording mode is on.
- When Recording mode is off, the audio from the **LINE (AUDIO OUT)** jacks may be interrupted, depending on the operation.
- The Recording mode switches off if you change the input function (**DVD/CD**, **TUNER**, etc.) or switch the power off.

Connecting using the component video output

Australian model only

If your TV has component video inputs, you can use these instead of the standard video output to connect this system to your TV.¹ This should give you the best quality picture from the three types of video output available.

- Use a component video cable to connect the **COMPONENT VIDEO OUT** to a set of component inputs on your TV.

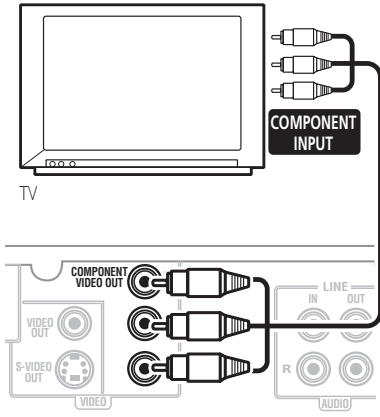

XV-DV131

About progressive scan video

Compared to interlace video, progressive scan video effectively doubles the scanning rate of the picture, resulting in a very stable, flicker-free image. Progressive scan video is available only from the component video output.



Important

- If you connect a TV that is not compatible with a progressive scan signal and switch the system to progressive, you will not be able to see any picture at all. In this case, press **⏻ STANDBY/ON** to put the system in standby, then press **SHIFT+SYSTEM SETUP**, use the **←/→** (cursor left/right) button to select **INTER L**. Press **ENTER** to set to interlace and switch the system back on.

Compatibility of this player with progressive-scan and high-definition TVs.

This player is compatible with progressive video Macro Vision System Copy Guard.²

This system is compatible with the following Pioneer displays and monitors: PDP-504HDE, PDP-434HDE.

Note

¹ The component video output is switchable between interlaced and progressive formats. See *Video Output settings* on page 21.
² Consumers should note that not all high-definition television sets are fully compatible with this product and may cause artifacts to be displayed in the picture. In case of 525 progressive scan picture problems, it is recommended that the user switch the connection to the 'standard definition' output (Interlace). If there are questions regarding our TV set compatibility with this model, please contact our customer service center.

Using the SCART AV output

U.K. model only

There are two different kinds of video outputs you can use to connect this system to your TV. The SCART output should give you better picture quality than the standard composite video output. The SCART AV connector functions as both a video and audio output.¹

- Use a commercially available SCART cable to connect the AV CONNECTOR to your TV.

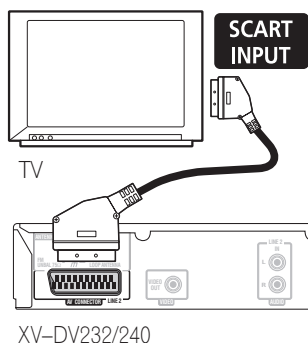

Pin No.	Assignment	Pin No.	Assignment
3	Audio L OUT	14	GND (video)
4	GND (audio)	15	R or C OUT
5	GND (video)	16	BLANK OUT
6	Audio L IN	17	GND (video)
7	B OUT	18	GND (video)
8	Status	19	Video or Y OUT
9	GND (video)	20	No connection
10	No connection	21	GND (video)
11	G OUT		

SCART pin assignment

The diagram below shows the SCART 21-pin connector assignment. This connector provides the video and audio signals for connection to a compatible color TV/monitor.

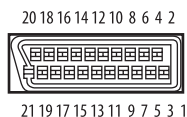

Pin No.	Assignment	Pin No.	Assignment
1	Audio R OUT	12	No connection
2	Audio R IN	13	GND (video)

Note

¹ SCART cables are available in several configurations. Make sure that the one you get will work with this system and your TV/monitor (see *SCART pin assignment* above).

Chapter 8

Controls and displays

Display

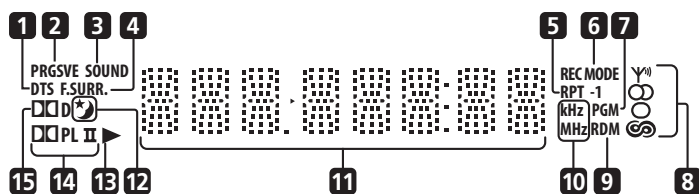
**1 DTS**

Lights during playback of a DTS source (page 11).

2 PRGSVE

Australian model only

Lights when progressive scan video output is selected (page 21).

3 SOUND

Lights when the SFC Modes or the tone controls (treble, bass or bass boost) are active (page 12).

4 F.SURR.

Lights when the Front Surround listening mode is selected (page 11).

5 RPT and RPT-1

RPT lights during repeat play. **RPT-1** lights during repeat one-track play (page 15).

6 REC MODE

Lights when Rec Mode is on (page 27).

7 PGM

Lights during program play (page 16).

8 Tuner indicators

Y^M – Lights when a broadcast is being received.

∞ – Lights when a stereo FM broadcast is being received in auto stereo mode.

○ – Lights when FM mono reception is selected.

∞ – (*U.K. model only*) Lights when in one of the RDS display or search modes.

9 RDM

Lights during random play (page 16).

10 kHz / MHz

Indicates the frequency unit shown in the character display (**kHz** for AM, **MHz** for FM).

11 Character display**12**

Lights when sleep timer is active (page 10).

13

Lights when a disc is playing.

14

Lights during Dolby Pro Logic II decoding (page 11).

15

Lights during playback of a Dolby Digital source (page 11).

Front panel

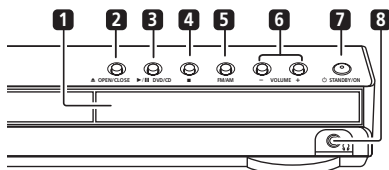

1 Display

See *Display* above for detailed information.

2 ▲ OPEN/CLOSE

Opens/closes the disc tray.

3 ▶/|| DVD/CD

Selects the **DVD/CD** function and starts/pauses/resumes playback.

4 ■

Stops playback.

5 FM/AM

Selects the tuner function and toggles between FM/AM bands.

6 VOLUME buttons

Adjusts the volume.

7 ⏻ STANDBY/ON

Switches the system on or into standby.

8 PHONES jack

Headphone jack.

Remote control

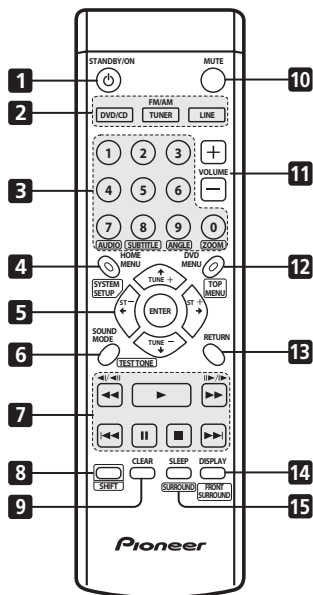

1 ⏻ STANDBY/ON

Switches the system on or into standby.

2 Function select buttons

Selects the source you want to listen to (**DVD/CD, TUNER, LINE**)

3 Number buttons

Select chapters/tracks from a disc directly. Press **DVD/CD** to access these controls:

SHIFT+AUDIO

Selects audio channel/language (page 17).

SHIFT+SUBTITLE

Displays/changes the subtitles (page 17).

SHIFT+ANGLE

Changes camera angle during DVD multi-angle scene playback (page 18).

SHIFT+ZOOM

Changes the screen zoom level (page 18).

4 HOME MENU

Displays (or exits) the on-screen menu for Initial Settings, Play Mode functions, etc.

SHIFT+SYSTEM SETUP

Use to make various system and surround sound settings (page 6, 10 and 37).

5 Cursor buttons, ENTER and tuning buttons**Cursor buttons**

Use the cursor buttons (↑/↓/←/→) to navigate on-screen displays and menus.

ENTER

Selects an option or executes a command.

TUNE +/-

Tunes the radio.

ST +/-

Selects station presets when listening to the radio.

6 SOUND MODE

Accesses the sound menu to adjust the SFC Mode, bass and treble, etc. (page 12 and 27)

SHIFT+TEST TONE

Outputs the test tone (for speaker setup) (page 6).

7 Disc playback controls

See *Basic playback controls* on page 7 and *Playing discs* on page 13 for an explanation of these controls.

8 SHIFT

Some of the buttons have alternate functions (they are outlined on the remote control). Press and hold **SHIFT** to access these.

9 CLEAR

Clears an entry.

10 MUTE

Mutes the sound (press again to cancel).

11 VOLUME +/-

Adjusts the volume.

12 DVD MENU

Press to display a DVD disc menu, or the Disc Navigator (page 8).

SHIFT+TOP MENU

Displays the top menu of a DVD disc in the play position—this may be the same as pressing **DVD MENU** (page 8).

13 RETURN

Returns to a previous menu screen.

14 DISPLAY

Displays/changes disc information shown on-screen (page 18) or to display RDS information (page 19).

SHIFT+FRONT SURROUND

Selects a Front Surround listening mode (page 11).

15 SLEEP

Press to set the sleep timer (page 10).

SHIFT+SURROUND

Selects a Surround mode (page 11).

Chapter 9



Additional information

Disc / content format playback compatibility

This player is compatible with a wide range of disc types (media) and formats. Playable discs will generally feature one of the following logos on the disc and/or disc packaging. Note however that some disc types, such as recordable CD and DVD, may be in an unplayable format.

See the *Disc compatibility table* below for more information.



-  is a trademark of Fuji Photo Film Co. Ltd.
-  is a trademark of DVD Format/Logo Licensing Corporation
- Also compatible with KODAK Picture CD

This player supports the IEC's Super VCD standard for superior picture quality, dual soundtracks, and widescreen support.



Disc compatibility table

Media	Compatible formats
CD-R/RW	<ul style="list-style-type: none"> • CD-Audio, Video CD/Super VCD, ISO 9660 CD-ROM* * ISO 9660 Level 1 or 2 compliant. CD physical format: Mode1, Mode2 XA Form1. Romeo and Joliet file systems are both compatible. • Multi-session playback: No • Unfinalized disc playback: No
DVD-R/RW	<ul style="list-style-type: none"> • DVD-Video, Video Recording (VR)* * Edit points may not play exactly as edited; screen may go momentarily blank at edited points. • Unfinalized playback: No • WMA/MP3/JPEG file playback on DVD-R/RW: No
PC-created disc	<ul style="list-style-type: none"> • Discs recorded using a PC may not be playable due to the setting of the software used to create the disc. In these instances, check the DVD-R/RW or CD-R/RW software manual or disc boxes for more on compatibility. • Discs recorded in packet write mode (UDF format) are not compatible.

Media	Compatible formats
Compressed audio	<ul style="list-style-type: none"> • MPEG-1 Audio Layer 3 (MP3), Windows Media Audio (WMA) • Sampling rates: 32, 44.1 or 48kHz • Bit-rates: Any (128Kbps or higher recommended) • VBR (variable bit rate) MP3 playback: No • VBR WMA playback: No • WMA lossless encoding: No • DRM (Digital Rights Management) compatible: Yes (DRM-protected audio files will <i>not</i> play in this player). • File extensions: .mp3, .wma (these must be used for the player to recognize MP3 and WMA files) • File structure: Up to 299 folders and up to 648 folders and files combined.
JPEG file	<ul style="list-style-type: none"> • Baseline JPEG and EXIF 2.2* still image files up to a resolution of 3072 x 2048. *File format for digital still cameras • Progressive JPEG compatible: No • File extensions: .jpg (must be used for the player to recognize JPEG files) • File structure: Up to 299 folders; up to 648 folders and files combined

About DivX

DivX is a compressed digital video format created by the DivX[®] video codec from DivXNetworks, Inc. This player can play DivX video files burned on CD-R/RW/ROM discs. Keeping the same terminology as DVD-Video, individual DivX video files are called 'Titles'. When naming files/titles on a CD-R/RW disc prior to burning, keep in mind that by default they will be played in alphabetical order.

Note

- For external subtitle files the following subtitle format filename extensions are supported (please note that these files are not shown within the disc navigation menu): .srt, .sub, .ssa, .smi
 - Some external subtitle files may be displayed incorrectly or not at all.
 - The filename of the movie file has to be repeated at the beginning of the filename for the external subtitle file.
 - The number of external subtitle files which can be switched for the same movie file is limited to a maximum of 10.

DivX video compatibility

- Official DivX[®] Certified product.
- Plays DivX[®] 5, DivX[®] 4, DivX[®] 3, and DivX[®] VOD video content (in compliance with DivX[®] Certified technical requirements).
- File extensions: .avi and .divx (these must be used for the player to recognize DivX video files). *Note that all files with the .avi extension are recognized as MPEG4, but not all of these are necessarily DivX video files and therefore may not be playable on this player.*

Displaying DivX subtitle files

The font sets listed below are available for DivX external subtitle files. You can see the proper font set on-screen by setting the **Subtitle Language** (in *Language settings* on page 22) to match the subtitle file.¹

ISO 8859-1 (also known as "Latin 1") covers the following West European languages:

Albanian (sq), Basque (eu), Catalan (ca), Danish (da), Dutch (nl), English (en), Faroese (fo), Finnish (fi), French (fr), German (de), Icelandic (is), Irish, (ga) Italian (it), Norwegian (no), Portuguese (pt), Rhaeto-Romanic (rm), Scottish (gd), Spanish (es), and Swedish (sv)

ISO 8859-2 (also known as "Latin 2") covers the following East European languages:

Albanian (sq), Croatian (hr), Czech (cs), Hungarian (hu), Polish (pl), Romanian (ro), Slovak (sk), Slovenian (sl)

ISO 8859-5 (also known as "Latin 5") covers the following Russian languages:

Bulgarian (bg), Byelorussian (be), Macedonian (mk), Russian (ru), Serbian (sr), Ukrainian (uk)

ISO 8859-8 (also known as "Latin 8") covers the following Hebraic languages:

Hebrew (iw), Yiddish (ji)

ISO 8859-9 (also known as “Latin 9”) covers the following Turkish languages:

Turkish (tr)

DivX, DivX Certified, and associated logos are trademarks of DivXNetworks, Inc. and are used under license.

About WMA



The Windows Media[®] logo printed on the box indicates that this player can playback Windows Media Audio content.

WMA is an acronym for Windows Media Audio and refers to an audio compression technology developed by Microsoft Corporation. WMA content can be encoded by using Windows Media[®] Player version 7, 7.1, Windows Media[®] Player for Windows[®] XP, or Windows Media[®] Player 9 Series.

Microsoft, Windows Media, and the Windows logo are trademarks, or registered trademarks of Microsoft Corporation in the United States and/ or other countries.

Using and taking care of discs

DVD Video regions

All DVD Video discs carry a region mark that indicates which region(s) of the world the disc is compatible with. Your DVD system also has a region mark (on the rear panel). Discs from incompatible regions will not play in this player. Discs marked **ALL** play in any player.

Handling discs

Hold the disc by its edges when handling so as not to leave fingerprints, dirt or scratches on either side of the disc. Damaged or dirty discs can affect playback performance.

If a disc becomes marked with fingerprints, dust, etc., clean using a soft, dry cloth.



Wipe lightly from the center of the disc using straight strokes. Don't wipe the disc surface with circular strokes.

If necessary, use a cloth soaked in alcohol, or a commercially available CD/DVD cleaning kit to clean a disc more thoroughly. Never use benzine, thinner or other cleaning agents such as those designed for cleaning vinyl records.

Storing discs

Avoid leaving discs in excessively cold, humid, or hot environments (including under direct sunlight). Don't glue paper or put stickers onto the disc, or use a pencil, ball-point pen or other sharp-tipped writing instrument. These could all damage the disc.

Discs to avoid

Discs spin at high speed inside the player. If a disc is cracked, chipped, warped, or otherwise damaged, don't risk using it in your player—you could end up damaging the unit.

This unit is designed for use with conventional, fully circular discs only. Pioneer disclaims all liability arising in connection with the use of shaped discs.

Installation and maintenance

Hints on installation

We want you to enjoy using this system for years to come, so please bear in mind the following points when choosing a location:

Do...

- ✓ Use in a well-ventilated room.
- ✓ Place on a solid, flat, level surface, such as a table, shelf or stereo rack.

Don't...

- ✗ Use in a place exposed to high temperatures or humidity, including near radiators and other heat-generating appliances.
- ✗ Place on a window sill or other place where the system will be exposed to direct sunlight.
- ✗ Use in an excessively dusty or damp environment.
- ✗ Place directly on top of an amplifier, or other component in your stereo system that becomes hot in use.
- ✗ Use near a television or monitor as you may experience interference—especially if the television uses an indoor antenna.
- ✗ Use in a kitchen or other room where the system may be exposed to smoke or steam.
- ✗ Use on a thick rug or carpet, or cover with cloth—this may prevent proper cooling of the system unit.
- ✗ Place on an unstable surface, or one that is not large enough to support all four of the system unit's feet.

Cleaning the pickup lens

The DVD player's lens should not become dirty in normal use, but if for some reason it should malfunction due to dust or dirt, consult your nearest Pioneer authorized service center. Although lens cleaners are commercially available, we do not recommend using them since some may damage the lens.

Problems with condensation

Condensation may form inside the player if it is brought into a warm room from outside, or if the temperature of the room rises quickly. Although the condensation won't damage the player, it may temporarily impair performance. Leave it to adjust to the warmer temperature for about an hour before switching on.

Moving the system unit

If you need to move the main unit, first remove a disc if there's one in the player, then press **STANDBY/ON** on the front panel to turn the system off. Wait for **GOOD BYE** to disappear from the display, then unplug the power cord.¹ Never lift or move the unit during playback—discs rotate at high speeds and may damage.

Screen sizes and disc formats

DVD-Video discs come in different screen aspects, ranging from TV programs, which are generally 4:3, to CinemaScope widescreen movies², with an aspect ratio of up to about 7:3. Televisions also come in different aspect ratios; 'standard' 4:3 and widescreen 16:9.³



Set to **4:3 (Letter Box)**, widescreen discs are shown with black bars top and bottom.



Set to **4:3 (Pan&Scan)**, widescreen discs are shown with the left and right sides cropped. Although the picture looks larger, you don't actually see the whole picture.

Note

- ¹ Unplugging the unit before **GOOD BYE** disappears from the display may cause the system to return to the factory settings.
- ² Many widescreen discs override the system's settings so that the disc is shown in letterbox format regardless of the setting.

TV system setting

The default setting of this system is **AUTO**, and unless you notice that the picture is distorted when playing some discs, you should leave it set to **AUTO**. If you find picture distortion with some discs, set the TV system to match your country or region's system. However, this may restrict the kinds of disc you can watch. See the table for the kinds of discs compatible with each setting (**AUTO**, **PAL** and **NTSC**).¹

- 1 Switch the unit into standby, then press **SHIFT+SYSTEM SETUP**.
- 2 Use **←/→** (cursor left/right) to choose **TV SYS** then press **ENTER**.

The TV system changes as follows:

- **AUTO** → **NTSC**
- **NTSC** → **PAL**
- **PAL** → **AUTO**

The system automatically switches on and you'll see the new TV system setting in the display after seeing **WELCOME**.²

Disc Type	Format	Player setting		
		NTSC	PAL	AUTO
DVD/Super VCD/ Video CD/DivX Video	NTSC	NTSC	PAL	NTSC
	PAL	NTSC	PAL	PAL
CD/MP3/WMA/ JPEG/no disc	—	NTSC	PAL	NTSC or PAL

Note

- 3 • Using the **16:9 (Wide)** setting with a standard 4:3 TV, or one of the **4:3** settings with a widescreen TV, will result in distortion.
 - When you watch discs recorded in 4:3 format, you can use the TV controls to select how the picture is presented. Your TV may offer various zoom and stretch options; see the instructions that came with your TV for details.
 - Some movie aspect ratios are wider than 16:9, so even with a widescreen TV, these discs will still play in a 'letterbox' style.

1 Most models of the newly developed countdown PAL TV system detect 50 Hz (PAL)/60 Hz (NTSC) and automatically switch vertical amplitude, resulting in a display without vertical shrinkage. However, in some cases, the image may appear without color. If your PAL TV does not have a V-Hold control, you may not be able to watch NTSC discs because of picture roll. If the TV has a V-Hold control, adjust it until the picture stops rolling. On some TVs, the picture may shrink vertically, leaving black bands at the top and bottom of the screen.

2 You have to switch the player into standby (press **⏻ STANDBY/ON**) before each change.

Frequency step setting

Australian model only

If you find that you can't tune into stations successfully, the frequency step may not be suitable for your country/region.

- 1 Switch the unit into standby, then press **SHIFT+SYSTEM SETUP**.
- 2 Use **←/→** (cursor left/right) to choose **AM 9K/10K** then press **ENTER**.
- 3 Use **↑/↓** (cursor up/down) to select **AM 9K** or **AM 10K** then press **ENTER**.

Troubleshooting

Incorrect operations are often mistaken for trouble and malfunctions. If you think that there is something wrong with this component, check the points below. Sometimes the trouble may lie in another component. Investigate the other components and electrical appliances being used. If the trouble cannot be rectified even after exercising the checks listed below, ask your nearest Pioneer authorized service center or your dealer to carry out repair work.

- If the system does not operate normally due to external effects such as static electricity disconnect the plug from the outlet and insert again to return to normal operating conditions.

General

Problem	Remedy
The power does not turn on, or switches off suddenly (an error message may be displayed at startup).	<ul style="list-style-type: none"> • Leave the unit plugged in, wait for one minute, then switch back on. • Make sure there are no loose strands of wire touching the unit. This could cause the system to shut off automatically. • Check that the speakers are connected correctly. • Make sure the voltage of the mains power source is correct for the model. • Try reducing the volume level. • If the problem persists, take it to your nearest Pioneer authorized service center or your dealer for servicing.
No sound is output when a function is selected.	<ul style="list-style-type: none"> • If you're using the line input, make sure the component is connected correctly (see <i>Connecting auxiliary components</i> on page 26). • Press MUTE on the remote control to turn muting off.
No image is output when playing discs.	<ul style="list-style-type: none"> • Make sure the TV is connected correctly (refer to the Setup Guide). • <i>Australian model only</i> – Reset the video output to interlace (see <i>Video Output settings</i> on page 21).
No sound from surround or center speakers.	<ul style="list-style-type: none"> • Refer to <i>Setting the channel levels</i> on page 6 to check the speaker levels. • When TUNER or LINE is selected, you can only hear the source in stereo. Switch the input source to DVD/CD for multichannel sound. • Check that the Recording mode hasn't been switched on (see <i>Recording mode</i> on page 27). • Check that you haven't selected the STEREO mode (see <i>Listening in surround sound</i> on page 11). • Connect the speakers properly (refer to the Setup Guide).
Can't operate the remote control.	<ul style="list-style-type: none"> • Replace the batteries (refer to the Setup Guide). • Operate within 7 m, 30° of the remote sensor (refer to the Setup Guide). • Remove any obstacles or operate from another position. • Avoid exposing the remote sensor on the front panel to direct light.
SND DEMO shows in the display and the unit can't be controlled.	<ul style="list-style-type: none"> • Press and hold ■ (stop) on the front panel for about five seconds. The disc tray ejects automatically to indicate the Sound Demo mode is disabled.

DVD/CD/Video CD player

Problem	Remedy
The disc is ejected automatically after loading.	<ul style="list-style-type: none"> • Clean the disc and align the disc properly in the disc guide. • If the region number on a DVD-video disc does not match the number on the player, the disc cannot be used (see <i>DVD Video regions</i> on page 35). • Allow time for any condensation inside the player to evaporate. Avoid using the player near an air-conditioning unit.
Playback not possible.	<ul style="list-style-type: none"> • If the disc is loaded upside down, reload the disc with label side face up.
Picture playback stops and buttons cannot be used.	<ul style="list-style-type: none"> • Press ■ (stop), then ► (play) to start playback again. • Switch the power off once, then on again using the front panel Ⓢ STANDBY/ON button.
Settings are canceled.	<ul style="list-style-type: none"> • When the power is cut, settings will be canceled.
No picture/No color.	<ul style="list-style-type: none"> • Check that connections are correct and that plugs are inserted fully. • Check the manual of the TV/monitor to make sure the settings are correct.
Screen is stretched or aspect doesn't change.	<ul style="list-style-type: none"> • The TV Screen setting is incorrect. Set the TV Screen option to match the TV/monitor you're using (see <i>Video Output settings</i> on page 21).
When recorded on a VCR or passed through an AV selector, there is disturbance in the playback picture.	<ul style="list-style-type: none"> • This system uses copy-protection technology which may prevent recording or cause picture problems when connected through a VCR or AV selector. This is not a malfunction.
Picture disturbance during playback or dark.	<ul style="list-style-type: none"> • This player is compatible with Macro-Vision System copy guard. Some discs include a copy prevention signal, and when this type of disc is played back, stripes etc., may appear on some sections of the picture depending on the TV. This is not a malfunction. • Discs respond differently to particular player functions. This may result in the screen becoming black for a brief instant or shaking slightly when the function is executed. These problems are largely due to differences between discs and disc content and are not malfunctions of this player.
Noticeable difference in DVD and CD volume.	<ul style="list-style-type: none"> • DVDs and CDs use different recording methods. This is not a malfunction.
CD-ROM disc is not recognized by the system.	<ul style="list-style-type: none"> • Make sure that the CD-ROM was recorded using the ISO 9660 disc format. See <i>Disc compatibility table</i> on page 33 for other disc compatibility information.
Files don't show up in the Disc Navigator/Photo Browser.	<ul style="list-style-type: none"> • The files on the disc must be named with the correct file extension: .mp3 for MP3 files; .wma for WMA files; .jpg for JPEG files (upper or lower-case is OK). See <i>Disc compatibility table</i> on page 33 for more on this.
Can't play WMA files.	<ul style="list-style-type: none"> • The files were recorded using DRM (digital rights management). This is not a malfunction.

Tuner

Problem	Remedy
Considerable noise in radio broadcasts.	<ul style="list-style-type: none"> • Connect the AM antenna (refer to the Setup Guide) and adjust the direction and position for best reception. You may also connect an additional internal or external AM antenna (refer to <i>Connecting auxiliary components</i> on page 26). • Fully extend the FM wire antenna, position for best reception, and secure to a wall. You may also connect an outdoor FM antenna (see <i>Connecting external antennas</i> on page 27). • Turn off other equipment that may be causing the noise or move it further away. • <i>Australian model only</i> – The tuning interval is incorrect for your country or region. Try switching the tuning interval (frequency step) (see <i>Frequency step setting</i> on page 37).
Auto tuning does not pick up some stations.	<ul style="list-style-type: none"> • The radio signal is weak. Auto tuning will only detect radio stations with a good signal. For more sensitive tuning, connect an outdoor antenna.

Error Messages

Message	Description
REC MODE	• An operation is prohibited because the Recording Mode is on (page 27).
SND DEMO	• The sound demo is on. See <i>General in Troubleshooting</i> on page 38.
CANNOT	• An operation is prohibited because headphones are connected, or TEST TONE is pressed during disc playback.
STEREO	• An operation is prohibited because the DVD/CD function isn't selected.
TRAY LOCK	• The tray lock is on. Contact your Pioneer authorized dealer for instructions.
MUTING	• An operation is prohibited because the sound is muted (press MUTE).
EEP ERROR	• Contact your Pioneer authorized service center or your dealer for servicing.
EXIT	• Appears when a menu is automatically exited after a set period of inactivity.

Resetting the system

Use this procedure to reset all system settings to the factory default.

- 1 **Switch the system on.**
- 2 **Press \odot STANDBY/ON while holding down the front panel FM/AM button.**
The next time you switch on, all the system settings should be reset.

Using the language code list

Some of the language options (see *Language settings* on page 22) allow you to set your preferred language from any of the 136 languages listed in the *Language code list* on page 41.

- 1 **Select 'Other Language'.**
- 2 **Use \leftarrow/\rightarrow (cursor left/right) to select either a code letter or a code number.**
- 3 **Use \uparrow/\downarrow (cursor up/down) to select a code letter or a code number.**

See the *Language code list* (next page) for a complete list of languages and codes.

Language code list

Language (Language code letter), **Language code**

Japanese (ja), 1001	Estonian (et), 0520	Lingala (ln), 1214	Slovak (sk), 1911
English (en), 0514	Basque (eu), 0521	Laothian (lo), 1215	Slovenian (sl), 1912
French (fr), 0618	Persian (fa), 0601	Lithuanian (lt), 1220	Samoan (sm), 1913
German (de), 0405	Finnish (fi), 0609	Latvian (lv), 1222	Shona (sn), 1914
Italian (it), 0920	Fiji (fj), 0610	Malagasy (mg), 1307	Somali (so), 1915
Spanish (es), 0519	Faroese (fo), 0615	Maori (mi), 1309	Albanian (sq), 1917
Dutch (nl), 1412	Frisian (fy), 0625	Macedonian (mk), 1311	Serbian (sr), 1918
Russian (ru), 1821	Irish (ga), 0701	Malayalam (ml), 1312	Siswati (ss), 1919
Chinese (zh), 2608	Scots-Gaelic (gd), 0704	Mongolian (mn), 1314	Sesotho (st), 1920
Korean (ko), 1115	Galician (gl), 0712	Moldavian (mo), 1315	Sundanese (su), 1921
Greek (el), 0512	Guarani (gn), 0714	Marathi (mr), 1318	Swedish (sv), 1922
Afar (aa), 0101	Gujarati (gu), 0721	Malay (ms), 1319	Swahili (sw), 1923
Abkhazian (ab), 0102	Hausa (ha), 0801	Maltese (mt), 1320	Tamil (ta), 2001
Afrikaans (af), 0106	Hindi (hi), 0809	Burmese (my), 1325	Telugu (te), 2005
Amharic (am), 0113	Croatian (hr), 0818	Nauru (na), 1401	Tajik (tg), 2007
Arabic (ar), 0118	Hungarian (hu), 0821	Nepali (ne), 1405	Thai (th), 2008
Assamese (as), 0119	Armenian (hy), 0825	Norwegian (no), 1415	Tigrinya (ti), 2009
Aymara (ay), 0125	Interlingua (ia), 0901	Occitan (oc), 1503	Turkmen (tk), 2011
Azerbaijani (az), 0126	Interlingue (ie), 0905	Oromo (om), 1513	Tagalog (tl), 2012
Bashkir (ba), 0201	Inupiak (ik), 0911	Oriya (or), 1518	Setswana (tn), 2014
Byelorussian (be), 0205	Indonesian (in), 0914	Panjabi (pa), 1601	Tonga (to), 2015
Bulgarian (bg), 0207	Icelandic (is), 0919	Polish (pl), 1612	Turkish (tr), 2018
Bihari (bh), 0208	Hebrew (iw), 0923	Pashto, Pushto (ps), 1619	Tsonga (ts), 2019
Bislama (bi), 0209	Yiddish (ji), 1009	Portuguese (pt), 1620	Tatar (tt), 2020
Bengali (bn), 0214	Javanese (jw), 1023	Quechua (qu), 1721	Twi (tw), 2023
Tibetan (bo), 0215	Georgian (ka), 1101	Rhaeto-Romanic (rm), 1813	Ukrainian (uk), 2111
Breton (br), 0218	Kazakh (kk), 1111	Kirundi (rn), 1814	Urdu (ur), 2118
Catalan (ca), 0301	Greenlandic (kl), 1112	Romanian (ro), 1815	Uzbek (uz), 2126
Corsican (co), 0315	Cambodian (km), 1113	Kinyarwanda (rw), 1823	Vietnamese (vi), 2209
Czech (cs), 0319	Kannada (kn), 1114	Sanskrit (sa), 1901	Volapük (vo), 2215
Welsh (cy), 0325	Kashmiri (ks), 1119	Sindhi (sd), 1904	Wolof (wo), 2315
Danish (da), 0401	Kurdish (ku), 1121	Sangho (sg), 1907	Xhosa (xh), 2408
Bhutani (dz), 0426	Kirghiz (ky), 1125	Serbo-Croatian (sh), 1908	Yoruba (yo), 2515
Esperanto (eo), 0515	Latin (la), 1201	Sinhalese (si), 1909	Zulu (zu), 2621

Country/Area code list

Country/Area, Country/Area code, **Country/Area code letter**

Argentina, 0118, ar	Hong Kong, 0811, hk	Philippines, 1608, ph
Australia, 0121, au	India, 0914, in	Portugal, 1620, pt
Austria, 0120, at	Indonesia, 0904, id	Russian Federation, 1821, ru
Belgium, 0205, be	Italy, 0920, it	Singapore, 1907, sg
Brazil, 0218, br	Japan, 1016, jp	Spain, 0519, es
Canada, 0301, ca	Korea, Republic of, 1118, kr	Switzerland, 0308, ch
Chile, 0312, cl	Malaysia, 1325, my	Sweden, 1905, se
China, 0314, cn	Mexico, 1324, mx	Taiwan, 2023, tw
Denmark, 0411, dk	Netherlands, 1412, nl	Thailand, 2008, th
Finland, 0609, fi	New Zealand, 1426, nz	United Kingdom, 0702, gb
France, 0618, fr	Norway, 1415, no	United States of America, 2119, us
Germany, 0405, de	Pakistan, 1611, pk	

Specifications

• Amplifier section

Continuous Power Output (RMS):

Front, Center, Surround . . . 60 W per channel
(1 kHz, 10 % T.H.D., 4 Ω)

50 W per channel

(1 kHz, 10 % T.H.D., 6 Ω)

Subwoofer . . . 60 W (100 Hz, 10 % T.H.D., 4 Ω)

50 W (100 Hz, 10 % T.H.D., 6 Ω)

• Disc section

Digital audio

characteristics DVD fs: 96 kHz, 24-bit

Type DVD system, Video CD/Super VCD

system and Compact Disc digital audio system

Frequency

response 4 Hz to 44 kHz (96kHz sampling) /

4 Hz to 22 kHz (48kHz sampling)

Wow and Flutter Limit of measurement

(± 0.001 % W.PEAK) or less (JEITA)

• FM tuner section

Frequency range 87.5 MHz to 108 MHz

Antenna 75 Ω , unbalanced

• AM tuner section

Frequency range:

With 9kHz step 531 kHz to 1,602 kHz

With 10kHz step (Not applicable

to the U.K. model). 530 kHz to 1,700 kHz

Antenna Loop antenna

• Miscellaneous

Power requirements:

U.K. model. AC 220-240 V, 50/60 Hz

Australian model AC 240 V, 50/60 Hz

Power consumption 45 W

Power consumption in standby. 0.4 W

Dimensions 420 (W) x 60 (H) x 331.5(D) mm

Weight 3.1 kg

• Accessories (DVD/CD receiver)

Remote control 1

AA/R6 dry cell batteries 2

Video cable (yellow plugs) 1

AM loop antenna 1

FM antenna 1

Power cord:

U.K. model. 1

Australian model 1

Setup Guide 1

Warranty card 1

These operating instructions 1

S-DV232, S-DV131 Speaker system

(Front speakers x2, surround speakers x2, center speaker x1, subwoofer x1)

• Front speakers

Enclosure Closed-box bookshelf type
(magnetically shielded)

System 7.7 cm 1-way system

Speakers. 7.7 cm cone type

Nominal impedance 6 Ω

Frequency range 90 Hz to 20 kHz

Maximum input power 60 W

Dimensions 105 (W) x 115 (H) x 114 (D) mm

Weight 0.6 kg

• Center speaker

Enclosure Closed-box bookshelf type
(magnetically shielded)

System 7.7 cm 1-way system

Speakers. 7.7 cm cone type

Nominal impedance 6 Ω

Frequency range 90 Hz to 20 kHz

Maximum input power 60 W

Dimensions 115 (W) x 105 (H) x 114 (D) mm

Weight 0.6 kg

• Surround speakers

Enclosure Closed-box bookshelf type
(magnetically shielded)

System 7.7 cm 1-way system

Speakers. 7.7 cm cone type

Nominal impedance 6 Ω

Frequency range 100 Hz to 20 kHz

Maximum input power 60 W

Dimensions 105 (W) x 118 (H) x 114 (D) mm

Weight 0.63 kg

• Subwoofer

Enclosure Bass-reflex floor type

System 16 cm 1-way system

Speaker. 16 cm cone type

Nominal impedance 6 Ω

Frequency range 30 Hz to 2.0 kHz

Maximum Input Power 60 W

Dimensions 190 (W) x 360 (H) x 317 (D) mm

Weight 4.2 kg

- **Accessories**

Non-skid pads (small) 12
 Non-skid pads (large) 4

S-DV340ST Speaker system

(Front speakers x2, surround speakers x2, center speaker x1)

- **Front speakers**

Enclosure Closed-box floorstanding type
 (magnetically shielded)

System 7.7 cm 2-way system

Speakers:

 Woofer 7.7 cm cone type

 Tweeter 2.0 cm ceramic type

Nominal impedance 6 Ω

Frequency range 85 Hz to 20 kHz

Maximum input power 100 W

Dimensions 260 (W) x 983.5 (H) x 260 (D) mm

Weight 3.7 kg

- **Center speaker**

Enclosure Closed-box bookshelf type
 (magnetically shielded)

System 7.7 cm 1-way system

Speakers 7.7 cm cone type

Nominal impedance 6 Ω

Frequency range 75 Hz to 20 kHz

Maximum input power 100 W

Dimensions 270 (W) x 90 (H) x 100 (D) mm

Weight 0.8 kg

- **Surround speakers**

Enclosure Closed-box bookshelf type
 (magnetically shielded)

System 7.7 cm 1-way system

Speakers 7.7 cm cone type

Nominal impedance 6 Ω

Frequency range 100 Hz to 20 kHz

Maximum input power 100 W

Dimensions 105 (W) x 118 (H) x 114 (D) mm

Weight 0.6 kg

- **Accessories**

Speaker cables 5

Non-skid pads (small) 4

Non-skid pads (large) 4

Front speaker stand bases 2

Screws (for base) 6

Brackets 2

Screws (for brackets) 4

S-DV240SW Speaker system

(Subwoofer x1)

- **Subwoofer**

Enclosure Bass-reflex floorstanding type

System 16 cm 1-way system

Speaker 16 cm cone type

Nominal impedance 6 Ω

Frequency range 30 Hz to 2.0 kHz

Maximum Input Power 60 W

Dimensions 190 (W) x 360 (H) x 317 (D) mm

Weight 4.2 kg



Note

- Specifications and design subject to possible modification without notice, due to improvements.

This product includes FontAvenue® fonts licenced by NEC corporation. FontAvenue is a registered trademark of NEC Corporation.

This product incorporates copyright protection technology that is protected by method claims of certain U.S. patents and other intellectual property rights owned by Macrovision Corporation and other rights owners. Use of this copyright protection technology must be authorized by Macrovision Corporation, and is intended for home and other limited uses only unless otherwise authorized by Macrovision Corporation. Reverse engineering or disassembly is prohibited.

Manufactured under license from Dolby Laboratories. "Dolby", "Pro Logic", and the double-D symbol are trademarks of Dolby Laboratories.

"DTS" and "DTS Digital Surround" are registered trademarks of Digital Theater Systems, Inc.

AFTER-SALES SERVICE FOR PIONEER PRODUCTS

Please contact the dealer or distributor from where you purchased the product for its after-sales service (including warranty conditions) or any other information. In case the necessary information is not available, please contact the Pioneer's subsidiaries (regional service headquarters) listed below:

PLEASE DO NOT SHIP YOUR PRODUCT TO THE COMPANIES at the addresses listed below for repair without advance contact, for these companies are not repair locations.

AMERICA

PIONEER ELECTRONICS (USA) INC.
CUSTOMER SUPPORT DIVISION
P.O. BOX 1760, LONG BEACH, CA 90801-1760, U.S.A.
CUSTOMER SERVICE HOTLINE : (800) 421-1404

EUROPE

PIONEER EUROPE NV
EUROPEAN SERVICE DIVISION
HAVEN 1087, KEETBERGLAAN 1, B-9120 MELSELE, BELGIUM

ASEAN

PIONEER ELECTRONICS ASIACENTRE PTE. LTD.
SERVICE DEPARTMENT
253, ALEXANDRA ROAD #04-01 SINGAPORE 159936

JAPAN AND OTHERS

PIONEER CORPORATION (HEAD OFFICE)
CUSTOMER SUPPORT CENTER
4-1, MEGURO 1-CHOME, MEGURO-KU, TOKYO 153-8654 JAPAN

5016_En

Published by Pioneer Corporation
Copyright ©2004 Pioneer Corporation
All rights reserved

PIONEER CORPORATION

4-1, Meguro 1-Chome, Meguro-ku, Tokyo 153-8654, Japan

PIONEER ELECTRONICS (USA) INC.

P.O. BOX 1540, Long Beach, California 90810-1540, U.S.A. TEL: (800) 421-1404

PIONEER ELECTRONICS OF CANADA, INC.

300 Allstate Parkway, Markham, Ontario L3R 0P2, Canada TEL: 1-877-283-5901

PIONEER EUROPE NV

Haven 1087, Keetberglaan 1, B-9120 Melsele, Belgium TEL: 03/570.05.11

PIONEER ELECTRONICS ASIACENTRE PTE. LTD.

253 Alexandra Road, #04-01, Singapore 159936 TEL: 65-6472-7555

PIONEER ELECTRONICS AUSTRALIA PTY. LTD.

178-184 Boundary Road, Braeside, Victoria 3195, Australia, TEL: (03) 9586-6300

PIONEER ELECTRONICS DE MEXICO S.A. DE C.V.

Bldv.Manuel Avila Camacho 138 10 piso Col.Lomas de Chapultepec, Mexico,D.F. 11000 TEL: 55-9178-4270

<05A000001>

Printed in

<ARB7329-A>